



Westshore Terminals Bailey Bridge Replacement



1973

Westshore History

1982



2013



Westshore 2017



Current Bailey Bridge
Built 1972, Moved 1983



Existing Bailey Bridge



- Single direction traffic flow
- Load rating 10,000 lbs
- Installed as temporary access in 1973 and moved in 1983.
- Structural inspections indicate approaching end of life.



Proposed Access Bridge



- Designed by Associated Engineering
- Bi-directional traffic
- Highway load ratings
- Meets current seismic criteria
- Very similar footprint to existing
- No impact on foreshore or adjacent properties
- Project cost \$4.25M

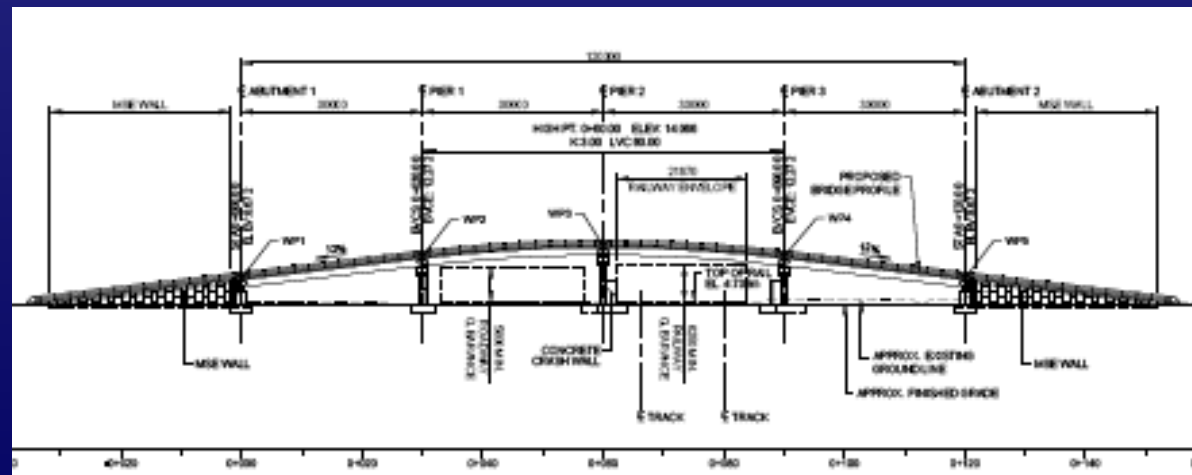
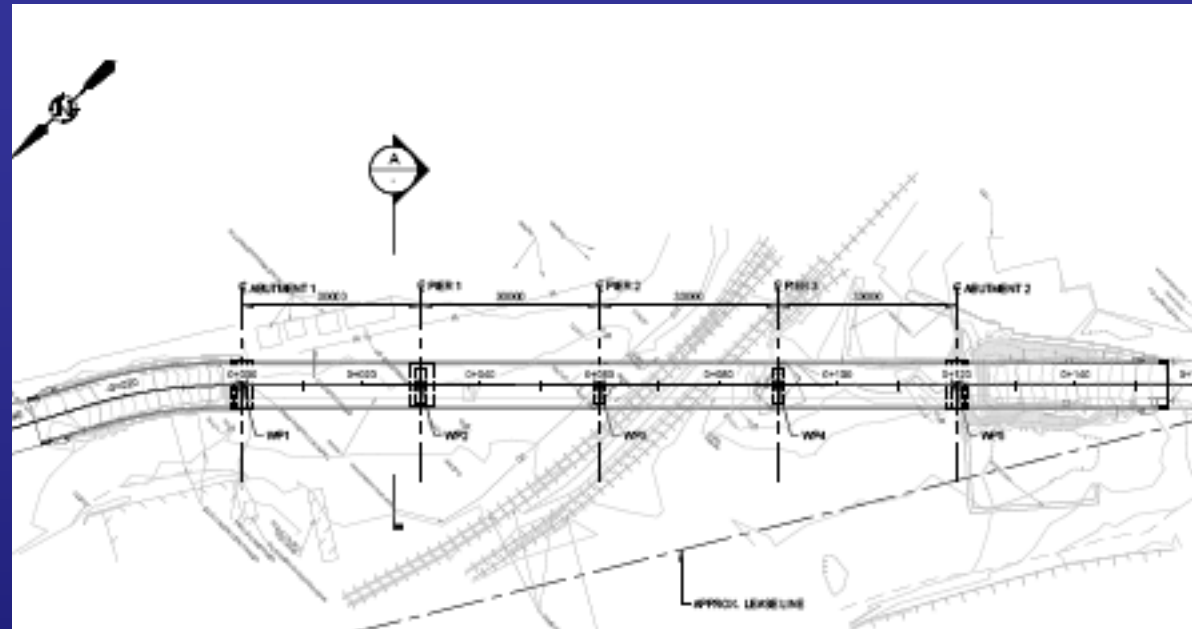



Questions?